

FOR LEASE

7

WALK-UP RETAIL/COMMERCIAL SERVICE SPACE GRAND AVENUE SOUTH, CAMBRIDGE

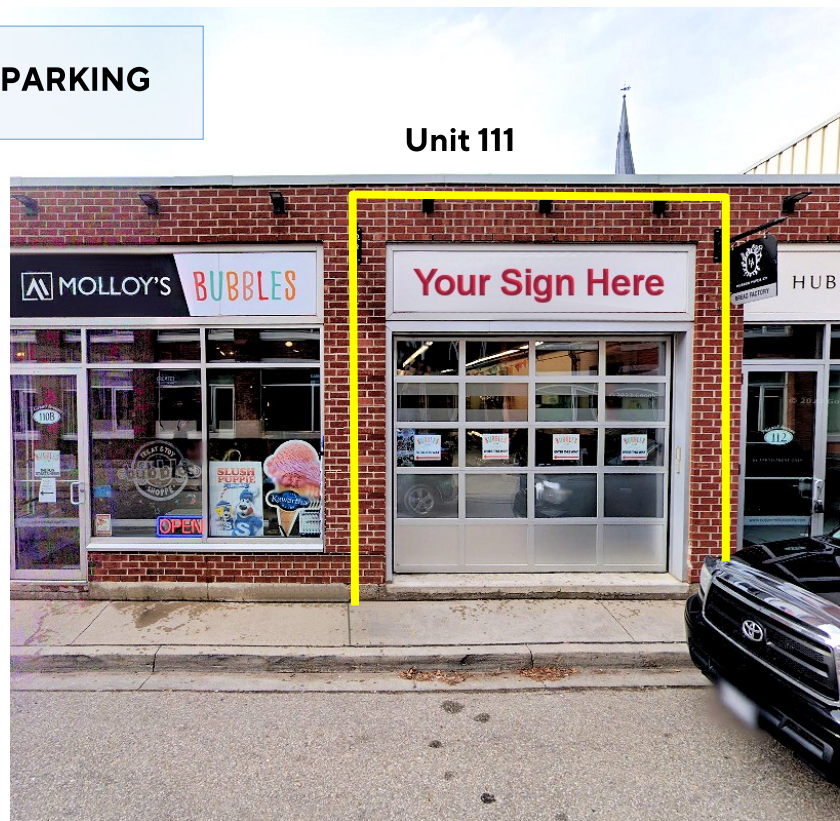

AVAILABILITY

Unit 109 - **UNDER CONTRACT**
Unit 111 - 849 sq ft

LEASE RATE

\$21.95/sq ft Net

ADDITIONAL RENT

\$8.30/sq ft
Plus Utilities

ZONING

(F)C1RM1

POSSESSION

60-90 days

- * Located on Grand Ave S/Melville St S, between Salisbury Ave and Main St in Galt Cambridge
- * Retail/Service commercial space in well maintained building
- * Unit 109 is currently operating as an art facility and craft outlet store.
- * Unit 111 is Currently operating as a treat and toy shop
- * On-site Parking
- * Wide range of uses possible with-in the zoning
- * High vehicle and foot traffic with great street exposure
- * Highly desired location, down the street from the gaslight district, close to transit and many other amenities

MATT DICKSON
SALES REPRESENTATIVE
MATT@COUPALMARKOU.COM
519-742-7000 x 104

MICHAEL CONRAD
SALES REPRESENTATIVE
MIKE@COUPALMARKOU.COM
519-742-7000 x 105

**COUPAL MARKOU COMMERCIAL
REAL ESTATE INC**
150 KING STREET SOUTH
WATERLOO, ONTARIO N2J 1P6
OFFICE 519-742-7000
FAX 519-742-7070

Coupal Markou
Commercial Real Estate Inc., Brokerage
www.coupalmarkou.com

FOR LEASE

7

WALK-UP RETAIL/COMMERCIAL SERVICE SPACE GRAND AVENUE SOUTH, CAMBRIDGE

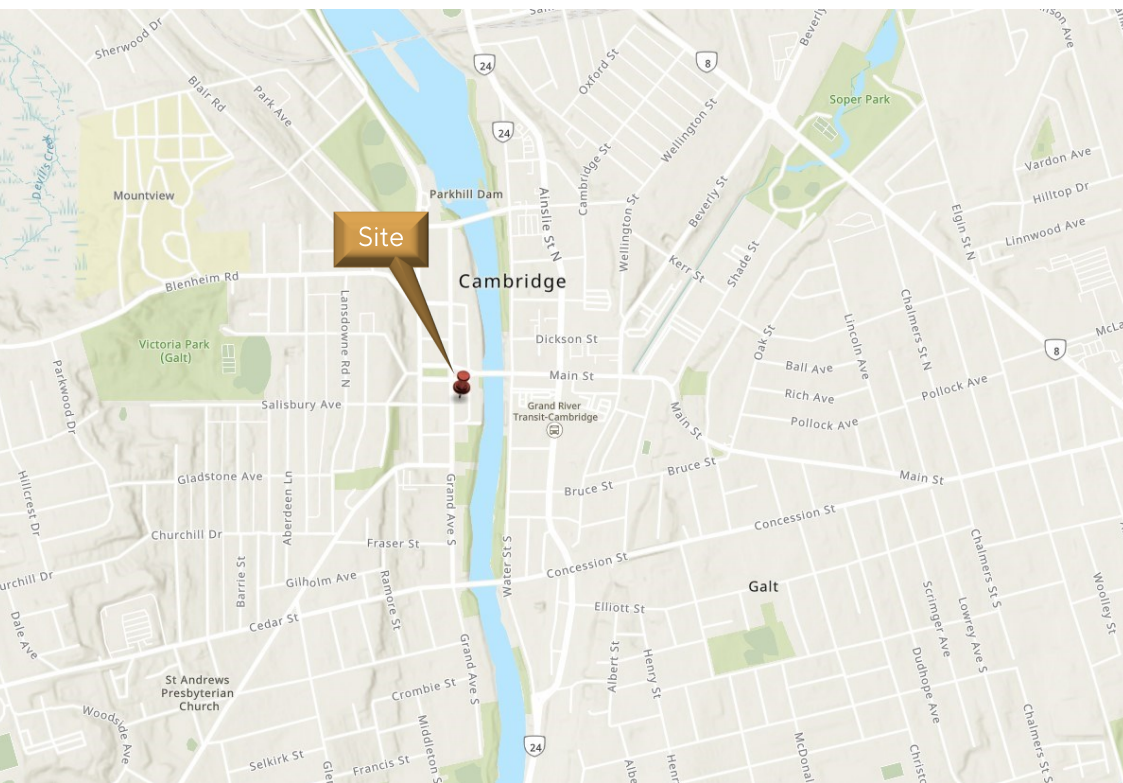
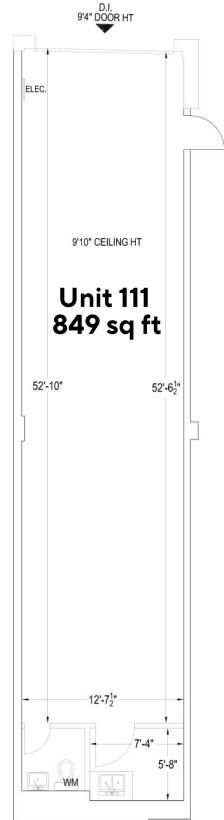
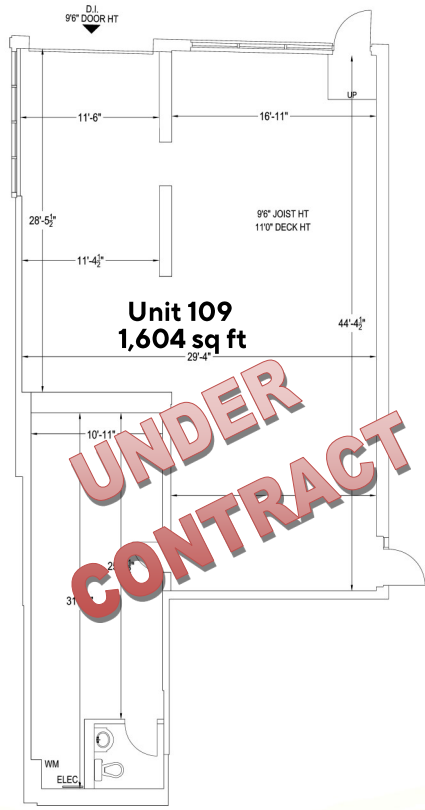

MATT DICKSON
SALES REPRESENTATIVE
MATT@COUPALMARKOU.COM
519-742-7000 x 104

MICHAEL CONRAD
SALES REPRESENTATIVE
MIKE@COUPALMARKOU.COM
519-742-7000 x 105

**COUPAL MARKOU COMMERCIAL
REAL ESTATE INC**
150 KING STREET SOUTH
WATERLOO, ONTARIO N2J 1P6
OFFICE 519-742-7000
FAX 519-742-7070



www.coupalmarkou.com

This disclaimer shall apply to Coupal Markou Commercial Real Estate Inc., Brokerage, to include all employees and independent contractors. The information set out herein is for advertising purposes, and any images, assumptions, estimates and property details have been obtained from sources deemed to be reliable. No warranty or representation is made as to its accuracy, correctness and completeness of the information, being subject to errors, omissions, conditions, prior sale / lease, withdrawal or other changes without notice. The recipient of the information should conduct its own inquiries and investigations prior to placing any reliance upon the information. MLS